

Contents

M2

M3

M4

M5

M6 and 1/4-20

3/8-24

Pins

Reference Spheres

Centerline Locators

PIN

## Pin Styli, Carbide, Ruby ball

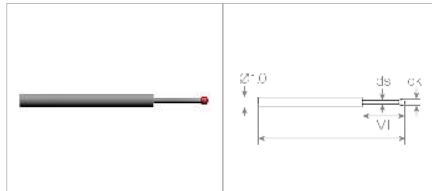

- ⊕ Ball: Ruby
- ⊕ Shank: Stainless Steel, reduced
- ⊕ Used with adapters on pages 143–144

Order Number	dk	ds	L	ML	Wt.
STY-N0.25-15.3-1NTF	0.25	0.2	15.3	2.5	0.2
STY-N0.3-15.3-1NTF	0.3	0.2	15.3	2.5	0.2
STY-N0.4-15.4-1NTF	0.4	0.3	15.4	2.5	0.2
STY-N0.5-15.5-1NTF	0.5	0.3	15.5	2.5	0.2
STY-N0.6-15.6-1NTF	0.6	0.4	15.6	4.5	0.3
STY-N0.7-15.7-1NTF	0.7	0.4	15.7	4.5	0.3
STY-N0.8-15.8-1NTF	0.8	0.6	15.8	4.5	0.3
STY-N0.9-15.9-1NTF	0.9	0.6	15.9	4.5	0.3
STY-N1.0-16-1NTF	1.0	0.8	16.0	4.5	0.4

SOLUTIONS®  
How it Works

Pin styli are a great alternative to custom probes. Used with holders on pages 143–144.



Modular pin / adapter styli assembly



Standard mounted styli

- ⊕ Feature – modularity
- ⊕ Benefit – interchangeability

Use the tools on pages 40-42 to properly assemble your styli configurations



© 2008 Paul W. Marino Gages, Inc.

© 2006 Paul W. Marino Gages, Inc.

Pin Styli

Pins

## Pin Styli, Carbide, Ruby ball

PIN

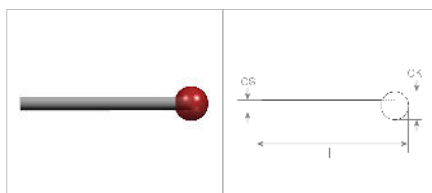

- ⊕ Ball: Ruby
- ⊕ Shank: Carbide
- ⊕ Use with adapters on pages 143–144

Order Number	dk	ds	L	ML	Wt.
STY-N1.35-26.4-1NTN	1.35	1.0	26.4	—	0.3
STY-N1.5-26.5-1NTN	1.5	1.0	26.5	—	0.3
STY-N2.0-26-1NTN	2.0	1.0	26.0	—	0.3
STY-N2.0-27-1.5NTN	2.0	1.5	27.0	—	0.6
STY-N2.0-45-1NTN	2.0	1.0	45.0	—	0.5
STY-N2.0-61-1NTN	2.0	1.0	61.0	—	0.7
STY-N2.0-81-1NTN	2.0	1.0	81.0	—	1.0
STY-N2.0-101-1NTN	2.0	1.0	101.0	—	1.3
STY-N2.5-27.5-1.5NTN	2.5	1.5	27.5	—	0.6
STY-N3.0-26.5-1.5NTN	3.0	1.5	26.5	—	0.7
STY-N3.0-38-2NTN	3.0	2.0	38.0	—	2.0
STY-N3.0-45-1.5NTN	3.0	1.5	45.0	—	1.0
STY-N3.0-61.5-1.5NTN	3.0	1.5	61.5	—	1.6
STY-N3.0-81.5-1.5NTN	3.0	1.5	81.5	—	2.2
STY-N4.0-27-2NTN	4.0	2.0	27.0	—	1.3
STY-N4.0-45-2NTN	4.0	2.0	45.0	—	2.1
STY-N4.0-62-2NTN	4.0	2.0	62.0	—	2.9
STY-N4.0-82-2NTN	4.0	2.0	82.0	—	3.9
STY-N4.0-102-2NTN	4.0	2.0	102.0	—	4.9
STY-N5.0-27.5-2NTN	5.0	2.0	27.5	—	1.4
STY-N5.0-42.5-2NTN	5.0	2.0	42.5	—	2.3
STY-N5.0-45-3NTN	5.0	3.0	45.0	—	6.0
STY-N5.0-62.5-2NTN	5.0	2.0	62.5	—	3.1
STY-N5.0-82.5-2NTN	5.0	2.0	82.5	—	4.0
STY-N5.0-102.5-2NTN	5.0	2.0	102.5	—	5.0
STY-N6.0-28-2NTN	6.0	2.0	28.0	—	1.6
STY-N6.0-43-2NTN	6.0	2.0	43.0	—	2.2
STY-N6.0-63-2NTN	6.0	2.0	63.0	—	3.2
STY-N6.0-83-2NTN	6.0	2.0	83.0	—	4.2
STY-N6.0-103-2NTN	6.0	2.0	103.0	—	4.9
STY-N6.0-103-3NTN	6.0	3.0	103.0	—	10.5

Continued on next page

Pin Styli  
© 2006 Paul W. Marino Gages, Inc.



PIN

## Pin Styli, Carbide, Ruby ball

Continued from previous page

Order Number	dk	ds	L	ML	Wt.
STY-N8.0-29-2NTN	8.0	2.0	29.0	—	2.0
STY-N8.0-44-3NTN	8.0	3.0	44.0	—	6.5
STY-N8.0-64-2NTN	8.0	2.0	64.0	—	3.6
STY-N8.0-73-3NTN	8.0	3.0	73.0	—	7.5
STY-N8.0-84-2NTN	8.0	2.0	84.0	—	4.5
STY-N8.0-103-3NTN	8.0	3.0	103.0	—	10.5

## Pin Styli, "T"-Style, Carbide, Ruby Ball

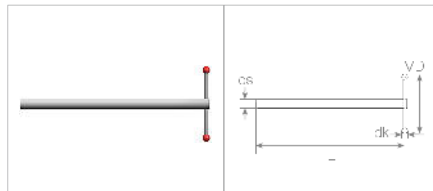

- ⊕ Ball: Ruby
- ⊕ Shank: Carbide.
- ⊕ Use with adapt-ers on pages 143-144

Order Number	dk	ds	L	MD	Wt.
STY-N1.0-50-2NTTH	1.0	2.0	50.0	10.0	3
STY-N1.0-100-2NTTH	1.0	2.0	100.0	10.0	5
STY-N2.0-50-2NTTH	2.0	2.0	50.0	20.0	3
STY-N2.0-100-2NTTH	2.0	2.0	100.0	20.0	5

© 2006 Paul W. Marino Gages, Inc.

Pin Styli

Pins

**SOLUTIONS®**  
"How it works"

© 2008 Paul W. Marino Gages, Inc.

## Adapters for Pin Styli

PIN

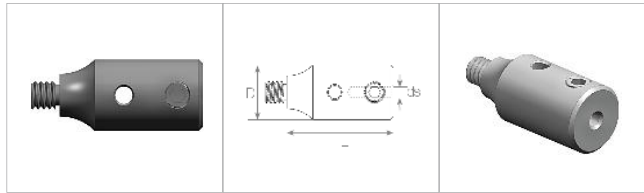

- ⊕ Adapter, Pin to M2
- ⊕ Stainless Steel
- ⊕ For use with Type F, Type N or Type H pin styli

Order Number	ds	L	D	Wt.
STY-N1.0NHZK	1.0	10.0	4.0	0.8

SOLUTIONS® "How it works" Use the tools on pages 40-42 to properly assemble your styli configurations



## Adapters for Pin Styli

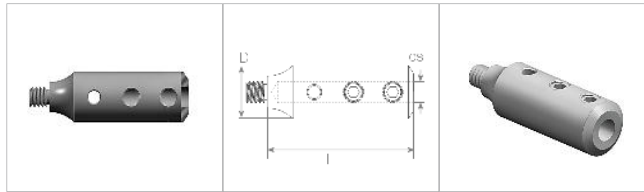

- ⊕ Adapter, Pin to M2, M3 or M4
- ⊕ Stainless Steel
- ⊕ For use with Type F, Type N or Type H pin styli
- ⊕ Ideal for long pin styli: features two set screws for secure fastening

Order Number	Thread	ds	L	D	Wt.
STY-N1.0NHZ	M2	1.0	14.0	5.0	1.7
STY-N1.5NHZ	M2	1.5	14.0	5.0	1.7
STY-N2.0NHZ	M2	2.0	14.0	5.0	1.6
STY-N3.0NHZ	M2	3.0	10.0	5.0	0.8
STY-N1.0-3NHZ	M3	1.0	14.0	5.0	1.7
STY-N1.5-3NHZ	M3	1.5	14.0	5.0	1.7
STY-N2.0-3NHZ	M3	2.0	14.0	5.0	1.6
STY-N1.0-4NHZ	M4	1.0	14.0	5.0	1.7
STY-N1.5-4NHZ	M4	1.5	14.0	5.0	1.7
STY-N2.0-4NHZ	M4	2.0	14.0	5.0	1.6

Adapters, Crossover  
© 2006 Paul W. Marano Gages, Inc.

Pins

PIN

## Adapters for Pin Styli

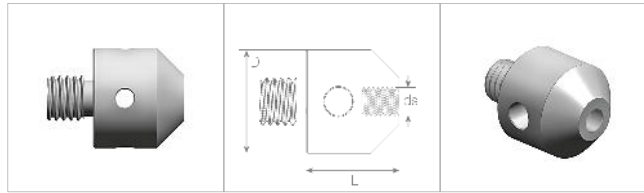

- ⊕ Adapter, Pin to M5
- ⊕ Stainless Steel
- ⊕ Use with up to 5 Type F, Type N or Type H pin styli to make a star.

Order Number	Thread	ds	L	D	Wt.
STY-N1.0-10-11NHT	M5	1.0	10.0	11.0	6.0
STY-N1.5-10-11NHT	M5	1.5	10.0	11.0	6.0
STY-N2.0-10-11NHT	M5	2.0	10.0	11.0	6.0

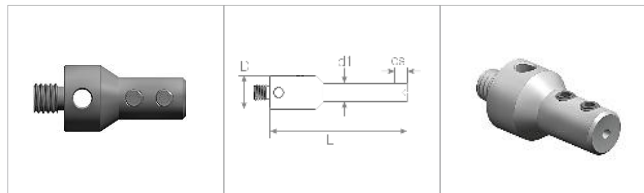

- ⊕ Adapter, Pin to M5
- ⊕ Stainless Steel
- ⊕ Use with Type F, Type N or Type H pin styli
- ⊕ Ideal for long pin styli: features two set screws for secure fastening

Order Number	Thread	ds	L	D	Wt.
STY-N1.0-20-11NHT	M5	1.0	20.0	11.0	9.0
STY-N1.5-20-11NHT	M5	1.5	20.0	11.0	9.0
STY-N2.0-20-11NHT	M5	2.0	20.0	11.0	9.0
STY-N3.0-20-11NHT	M5	3.0	2.00	11.0	9.0

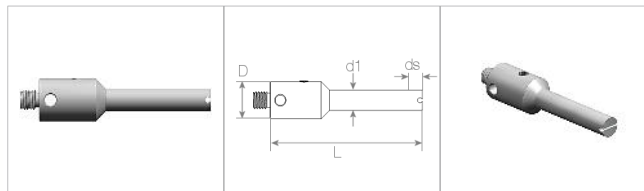

- ⊕ Adapter, right angle, Pin to M5
- ⊕ Stainless Steel
- ⊕ For use with pin styli with 1.0 mm diameter shank

Order Number	Thread	ds	L	D	Wt.
STY-N1.0-45-11NHT	M5	1.0	45.0	11.0	16.0

Adapters, Crossover  
© 2006 Paul W. Marino Gages, Inc.

Pins

## Adapters for Pin Styli

PIN

SOLUTIONS®  
“How it works

All pin styli can be used with the adapters and holders shown on pages 143–144 to create custom configurations specific to your needs

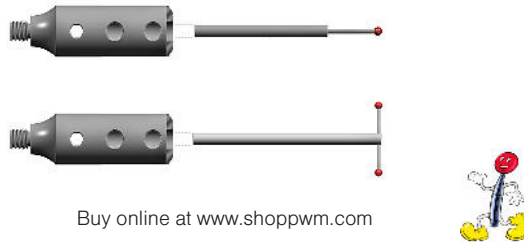

## 5 Piece Kit, Pin Styli

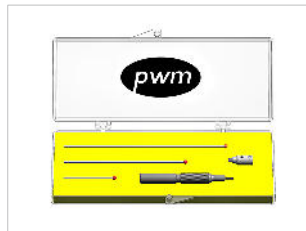

- ⊕ Ball: Ruby
- ⊕ Shank: Stainless Steel
- ⊕ Plastic case

PWM Order Number STY-KM2-2.0NTN, 5 piece pin styli kit

Contents	Qty	Description
STY-N2.0-26NTN	1	Stylus 26 mm x 2.0 mm
STY-N2.0-61NTN	1	Stylus 61 mm x 2.0 mm
STY-N2.0-81NTN	1	Stylus 81 mm x 2.0 mm
STY-N1.0NHZ	1	Holder M2, for 1.0 mm shank pins
STY-N0.9NWSE	1	Hex key for holder set screws

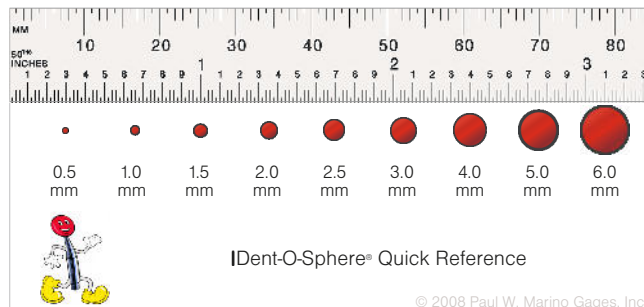

Adapters, Crossover and Pin Stylus Kit

Pins

PIN

## Electronic Height Gage

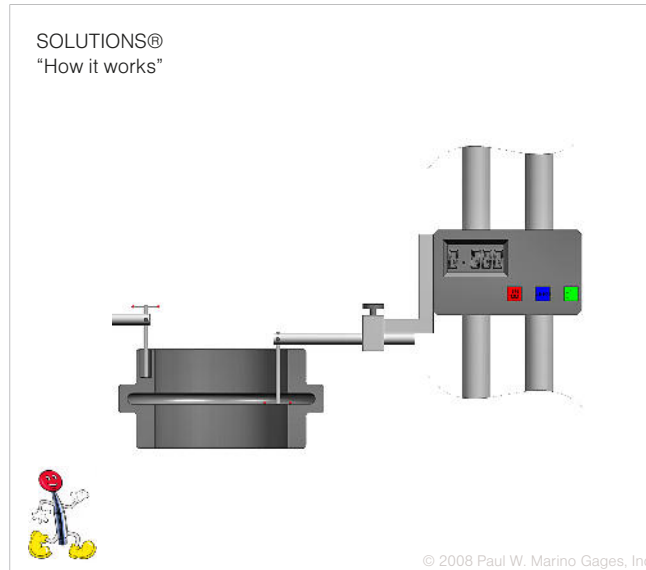

### Universal Holder for M2 Styli

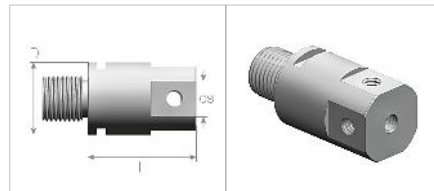

- ⊕ Stainless Steel
- ⊕ Use with any M2 stylus
- ⊕ Used with Type A or B shanks on page 147.

Order No.	L	D	ds	Wt.
STY-N7.0NHS	12.0	8.0	M2	5.0

Adapters for Height Gages  
© 2008 Paul W. Marino Gages, Inc.

### Universal Holder for Pin Styli

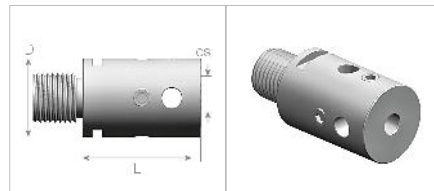

- ⊕ Stainless Steel
- ⊕ Use with Type F, N and T pin styli
- ⊕ Used with Type A or B shanks on page 147.

Order No.	L	D	ds	Wt.
STY-N1.0NHH	12.0	8.0	1.0	4.0
STY-N2.0NHH	12.0	8.0	2.0	4.0
STY-N3.0NHH	12.0	8.0	3.0	3.0

Pins



## Universal Shanks

PIN

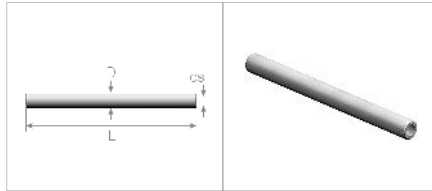

- ⊕ Stainless Steel
- ⊕ Trimos, Wenzel, Mahr, Vertex and Mitutoyo Electronic Height Gages.
- ⊕ Used with holders on page 146

Order No.	L	ML	ds	D	d1	Wt.
STY-N8.0-90NSA	90.0	—	M5x.5	8.0	—	24.0

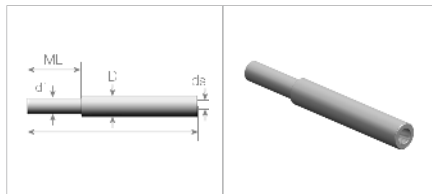

- ⊕ Stainless Steel
- ⊕ Tesa Electronic Height Gages.
- ⊕ Used with holders on page 146

Order No.	L	ML	ds	D	d1	Wt.
STY-N6.0-63NSB	63.0	50.0	M5x.5	6.0	6.0	19.0

### SOLUTIONS® "How it works"

Purchase a Type A or B shaft, a pin stylus holder and an M2 stylus holder and build a complete modular set for any measuring need. Just add styli – be creative and add knuckles, adapters or other accessories.

Shanks are compatible with Mahr, Mitutoyo, Tesa, Trimos, Vertex and Wenzel Electronic Height Gages.

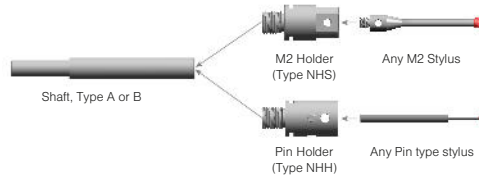

Buy online at [www.shoppwm.com](http://www.shoppwm.com)



© 2008 Paul W. Marino Gages, Inc.

Shanks for Height Gages

© 2006 Paul W. Marino Gages, Inc.

Pins

PIN

Fixed Shanks / Holders

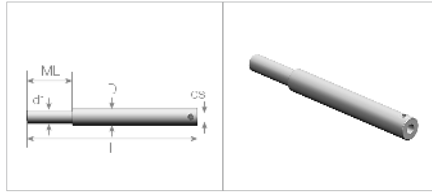

- ⊕ Stainless Steel
- ⊕ One piece shank and holder
- ⊕ Use with pin styli with a 3.0 mm shank
- ⊕ Tesa Electronic Height Gages

Order No.	L	ML	ds	D	d1	Wt.
STY-N6.0-75NHC	75.0	20.0	3.0	8.0	6.0	20.0

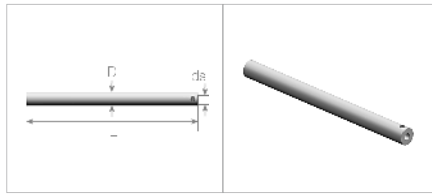

- ⊕ Stainless Steel
- ⊕ One piece shank and holder
- ⊕ Use with pin styli with a 3.0 mm shank
- ⊕ Mahr, Mitutoyo, Trimos, Vertex, Wenzel, and Electronic Height Gages

Order No.	L	ML	ds	D	d1	Wt.
STY-N8.0-100NHD	100.0	—	3.0	8.0	—	25.0

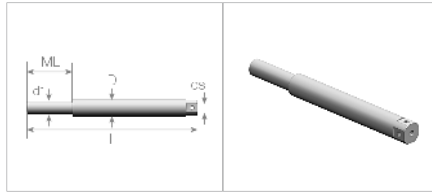

- ⊕ Stainless Steel
- ⊕ One piece shank and holder
- ⊕ Use with any M2 stylus
- ⊕ Tesa Electronic Height Gages

Order No.	L	ML	ds	D	d1	Wt.
STY-N6.0-75NHE	75.0	20.0	M2	8.0	6.0	20.0

Shanks for Height Gages  
© 2006 Paul W. Marmore Gages, Inc.

Pins

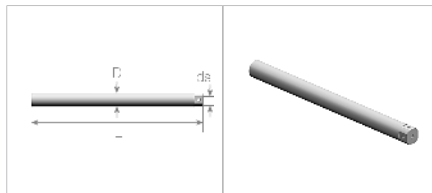

- ⊕ Stainless Steel
- ⊕ One piece shank and holder
- ⊕ Use with any M2 stylus
- ⊕ Mahr, Mitutoyo, Trimos, Vertex, Wenzel, and Electronic Height Gages

Order No.	L	ML	ds	D	d1	Wt.
STY-N8.0-100NHF	100.0	—	M2	8.0	—	25.0

## Electronic Height Gage Kit

PIN

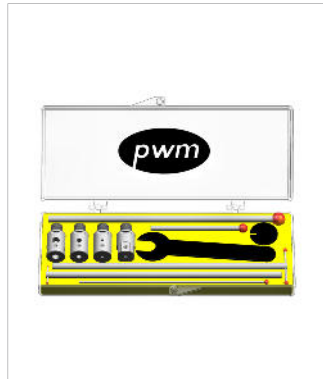

- ⊕ Ball: Ruby
- ⊕ Shank: Carbide
- ⊕ Comprehensive accessory kit for electronic height gages.
- ⊕ Plastic case

PWM Order Number					
STY-N8.0NHSA	Shank diameter, 8.0 mm				
STY-N6.0NHSA	Shank diameter, 6.0 mm				
Both kits include:					
Contents	Description	L	dk	ds	Wt.
STY-N1.0-100-3NTTH	T Stylus	100.0	1.0	—	10.0
STY-N2.0-100-3NTTH	T Stylus	100.0	2.0	—	10.3
STY-N2.0-81-1NTN	Pin Stylus	81.0	2.0	—	1.0
STY-N4.0-42-2NTN	Pin Stylus	42.0	4.0	—	
STY-N6.0-103-3NTN	Pin Stylus	103.0	6.0	—	4.9
STY-N1.0NHH	Stylus Holder	12.0	—	1.0	4
STY-N2.0NHH	Stylus Holder	12.0	—	2.0	4
STY-N3.0NHH	Stylus Holder	12.0	—	3.0	4
STY-N7.0NHS	Stylus Holder	12.0	—	M2	5
STY-N1.5NWSK	Wrench, 1.5 mm for Type C, D and H Holders				
STY-N6.5NWGA	Wrench, 6.5 mm for Type H and S Holders				

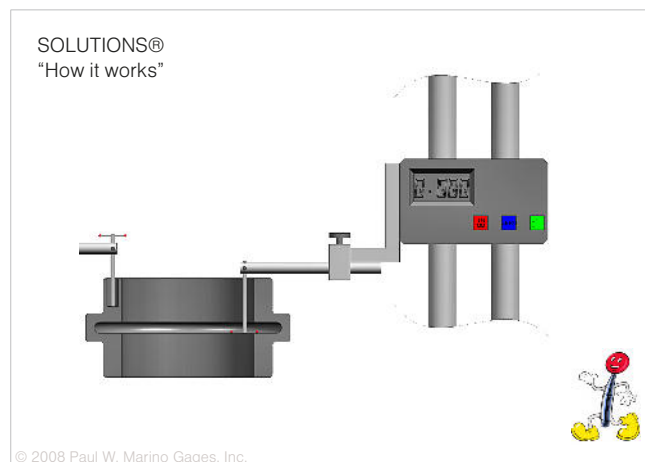

Kits for Height Gages  
© 2006 Paul W. Marino Gages, Inc.

Pins

PIN

### Electronic Height Gage Kit



- ⊕ Ball: Ruby
- ⊕ Shank: Carbide
- ⊕ T Stylus kit for electronic height gages.
- ⊕ Plastic case

PWM Order Number STY-N6.0NHSC, 3 piece kit

Contents	Description	L	dk	ds	D	Wt.
STY-N1.0-100-3NTTH	T Stylus	100.0	1.0	3.0	—	—
STY-N6.0-75NHC	Stylus Holder	75.0	—	3.0	6.0	20
STY-N1.5NWSK	Hex Wrench	55.0	—	—	—	—



- ⊕ Ball: Ruby
- ⊕ Shank: Carbide
- ⊕ T Stylus kit for electronic height gages.
- ⊕ Plastic case

Kits for Height Gages  
© 2006 Paul W. Marino Gages, Inc.

PWM Order Number STY-N6.0NHSD, 3 piece kit

Contents	Description	L	dk	ds	D	Wt.
STY-N2.0-100-3NTTH	T Stylus	100.0	2.0	3.0	—	—
STY-N6.0-75NHC	Stylus Holder	100.0	—	3.0	6.0	20
STY-N1.5NWSK	Hex Wrench	55.0	—	—	—	—

Pins

Buy online at [www.shoppwm.com](http://www.shoppwm.com)

## Electronic Height Gage Kit

PIN

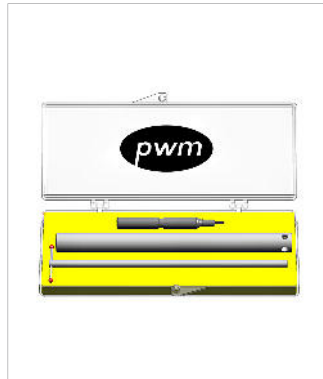

- ⊕ Ball: Ruby
- ⊕ Shank: Carbide
- ⊕ T Stylus kit for electronic height gages.
- ⊕ Plastic case

PWM Order Number STY-N8.0NHSE, 3 piece kit						
Contents	Description	L	dk	ds	D	Wt.
STY-N1.0-100-3NTTH	T Stylus	100.0	1.0	3.0	—	—
STY-N8.0-100NHD	Stylus Holder	100.0	—	3.0	8.0	20
STY-N1.5NWSK	Hex Wrench	55.0	—	—	—	—

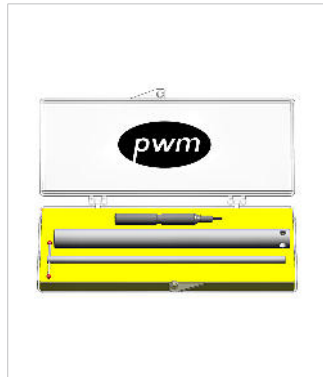

- ⊕ Ball: Ruby
- ⊕ Shank: Carbide
- ⊕ T Stylus kit for electronic height gages.
- ⊕ Plastic case

PWM Order Number STY-N8.0NHSE, 3 piece kit						
Contents	Description	L	dk	ds	D	Wt.
STY-N2.0-100-3NTTH	T Stylus	100.0	2.0	3.0	—	—
STY-N8.0-100NHD	Stylus Holder	100.0	—	3.0	8.0	20
STY-N1.5NWSK	Hex Wrench	55.0	—	—	—	—

Kits for Height Gages  
© 2006 Paul W. Marino Gages, Inc.

Pins

PIN

Notes:

---

---

---

---

---

---

---

---

---

---

SOLUTIONS®  
"How it works"

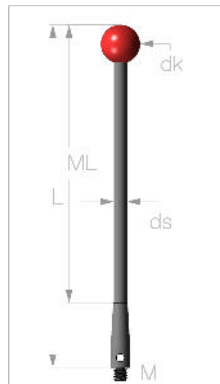

Call Out	Description
dk	Ball diameter
ds	Shank diameter
D	Ferrule diameter
L	Overall length
ML	Working length
M	Thread
Wt.	Approximate weight, in grams

Drawings are not to scale.  
Consult charts for actual dimensions.

Ball Data

- ⊕ Balls are grade 6 to 10, depending on diameter. Refer to the Technical Data on page 8 for more complete information.
- ⊕ Available ball materials:
  1. Ruby and Sapphire (AL<sub>2</sub>O<sub>3</sub> monocrystalline)
  2. Ceramic (AL<sub>2</sub>O<sub>3</sub> polycrystalline)
  3. Silicone Nitride available on request
  4. Other materials are available



©2006 Paul W. Marino Gauges, Inc.

Notes

Pins